



LEGEND

- 3 - ROOM
- 4 - ROOM
- 5 - ROOM
- RESERVED FOR / EXISTING DEVELOPMENT
- DROP - OFF PORCH / PERGOLA / LINKWAY
- EATING HOUSE (EH) / SHOPS (S) & SUPERMARKET (SM) AT 1ST STOREY
- CHILD CARE CENTRE (CCC) / EDUCATION CENTRE (EC) / STUDENT CARE CENTRE (SCC) / RESIDENTS' COMMITTEE CENTRE (RCC) / COMMUNITY CORNER (CC) AT 1ST STOREY
- CHILDREN PLAYGROUND (PG) / ADULT FITNESS STATION (AFS) / ELDERLY FITNESS STATION (EFS)
- OPEN SPACE
- STAIRCASE
- ACCESS WAY TO BASEMENT CARPARK
- ELECTRICAL SUB-STATION (ESS) AT 1ST STOREY
- AIRWELL OVER CARPARK
- LIFT
- CENTRALISED REFUSE CHUTE / CHUTE FOR RECYCLABLE REFUSE
- SERVICE BAYS

Waterway Terraces

Premium Flats

The information contained herein is subject to change at any time without notice and cannot form part of an offer or contract. The proposed facilities and their locations as shown are only estimates. The proposed facilities may include other ancillary uses allowed under URA's prevailing Development Control guidelines. For example, places of worship may also include columbarium as an ancillary use, while community centres may also include childcare centres. The implementation of the facilities is subject to review by the Government or competent authorities. While reasonable care has been taken in providing this information, HDB shall not be responsible in any way for any damage or loss suffered by any person whether directly or indirectly as a result of reliance on the said information or as a result of any error or omission therein.

SCALE 0m 10 20 30 40 50 100m



Block Number	Number of storeys	3 Room	4 Room	5 Room	Total	Lift opens at
308A	8/18	68	248	140	456	Every storey
308B	9/18	34	166	82	282	Every storey
308C	7/18	76	174	84	334	Every storey
Total		178	588	306	1072	

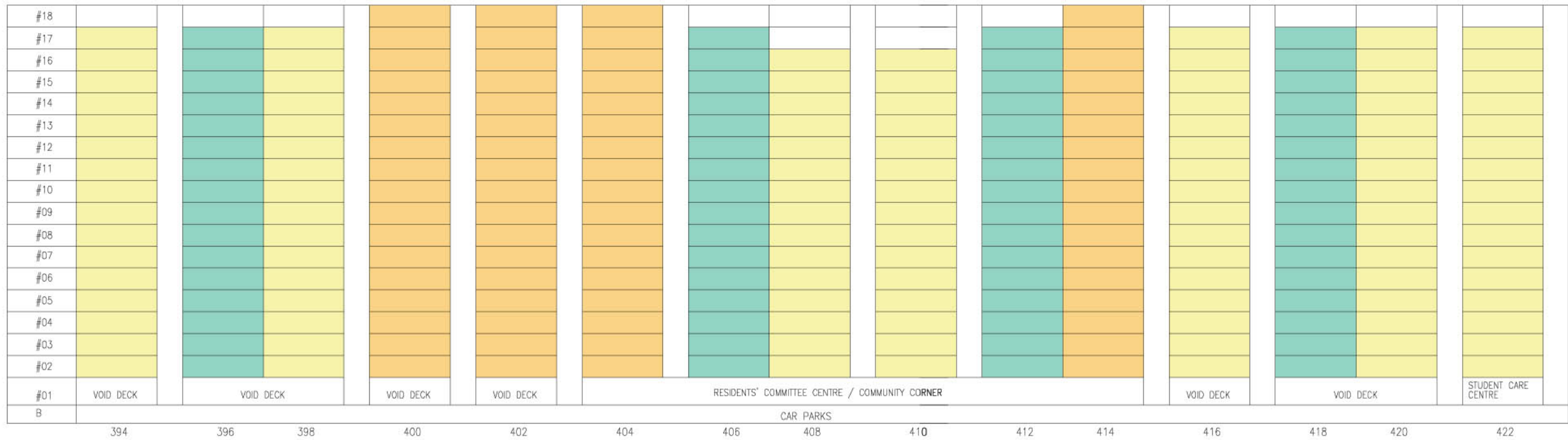

Unit Distribution

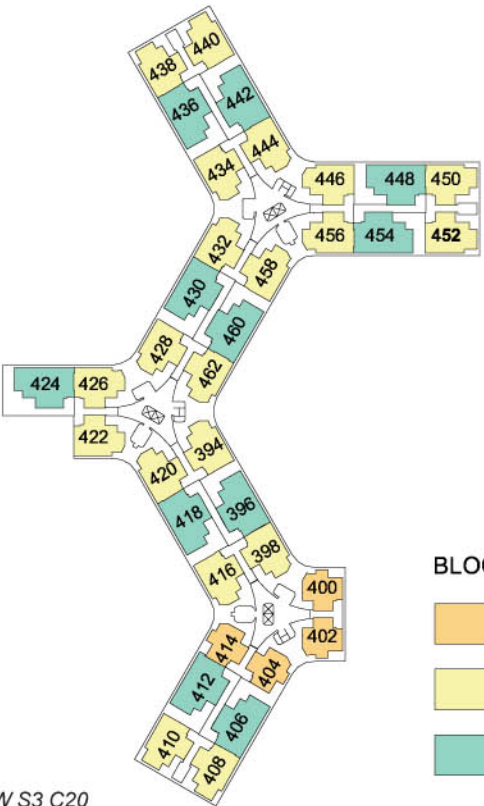
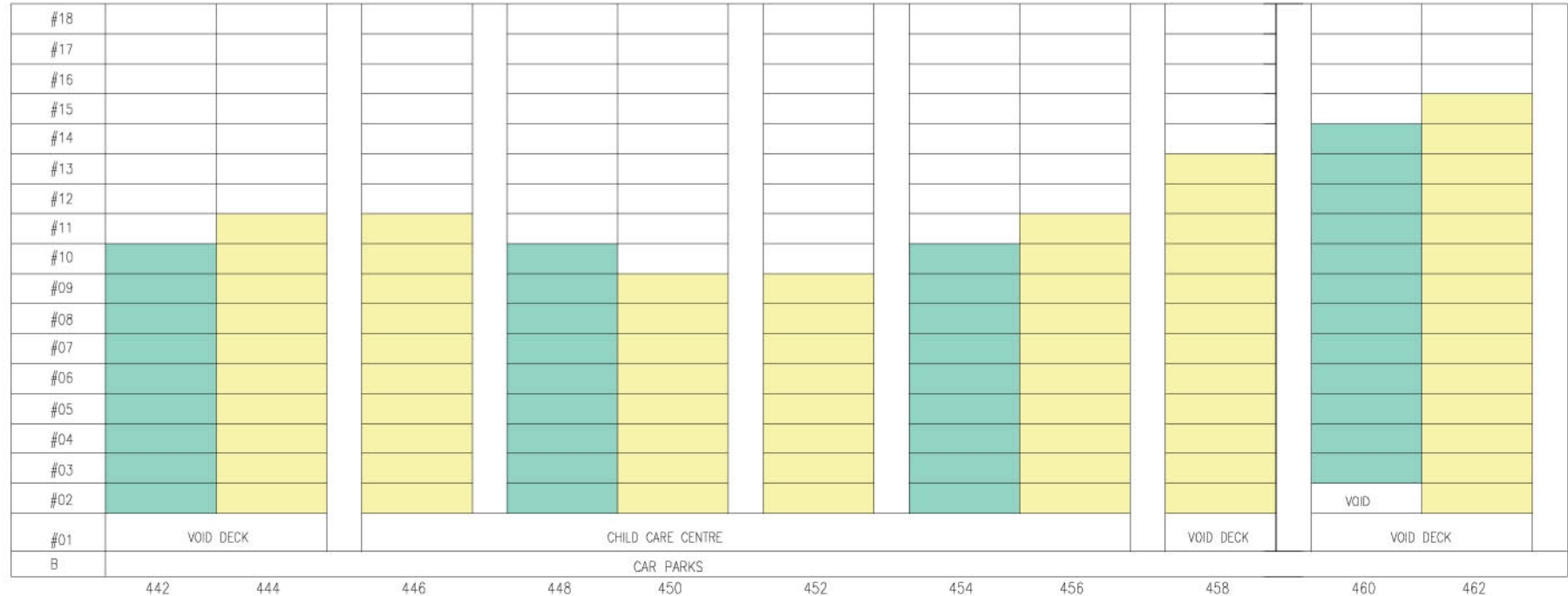
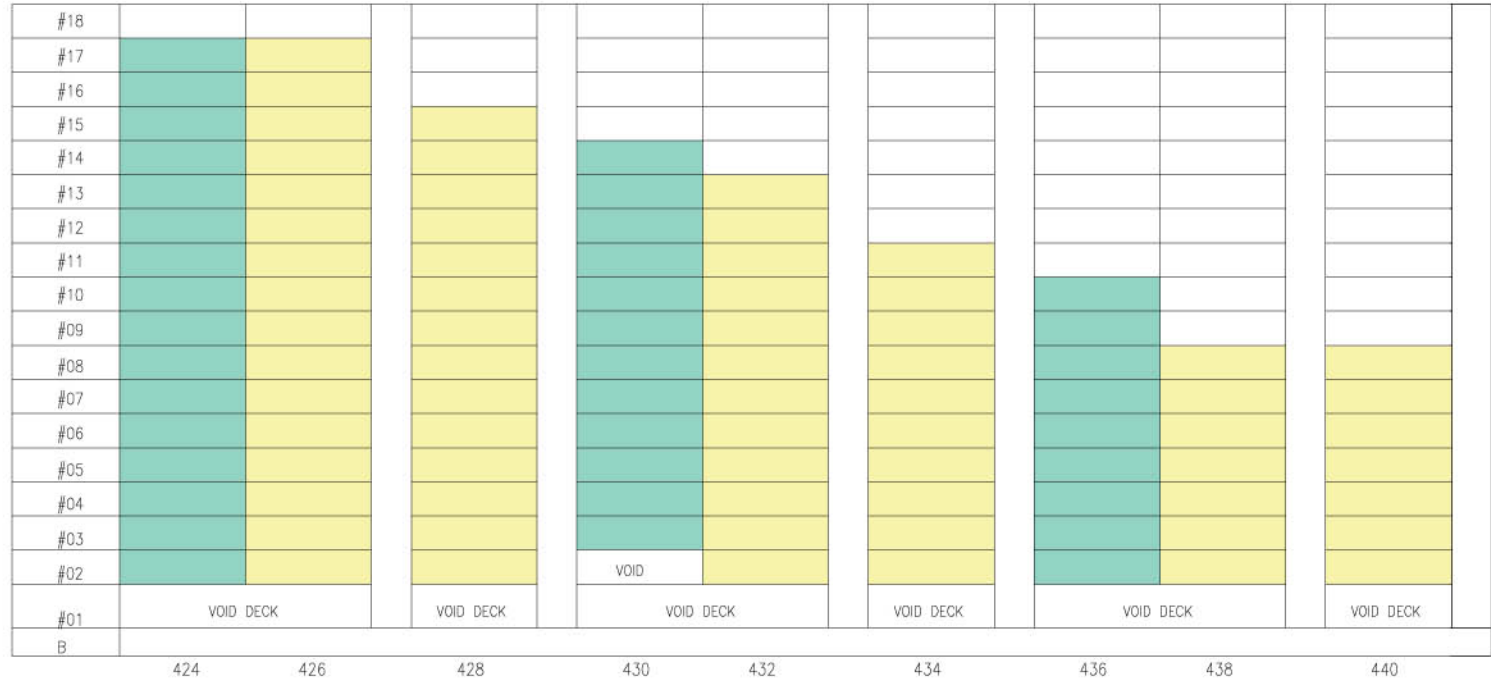

BLOCK 308A

- 3 ROOM
- 4 ROOM
- 5 ROOM

Unit Distribution

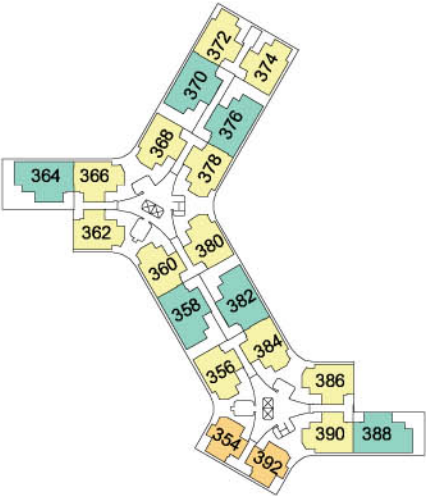
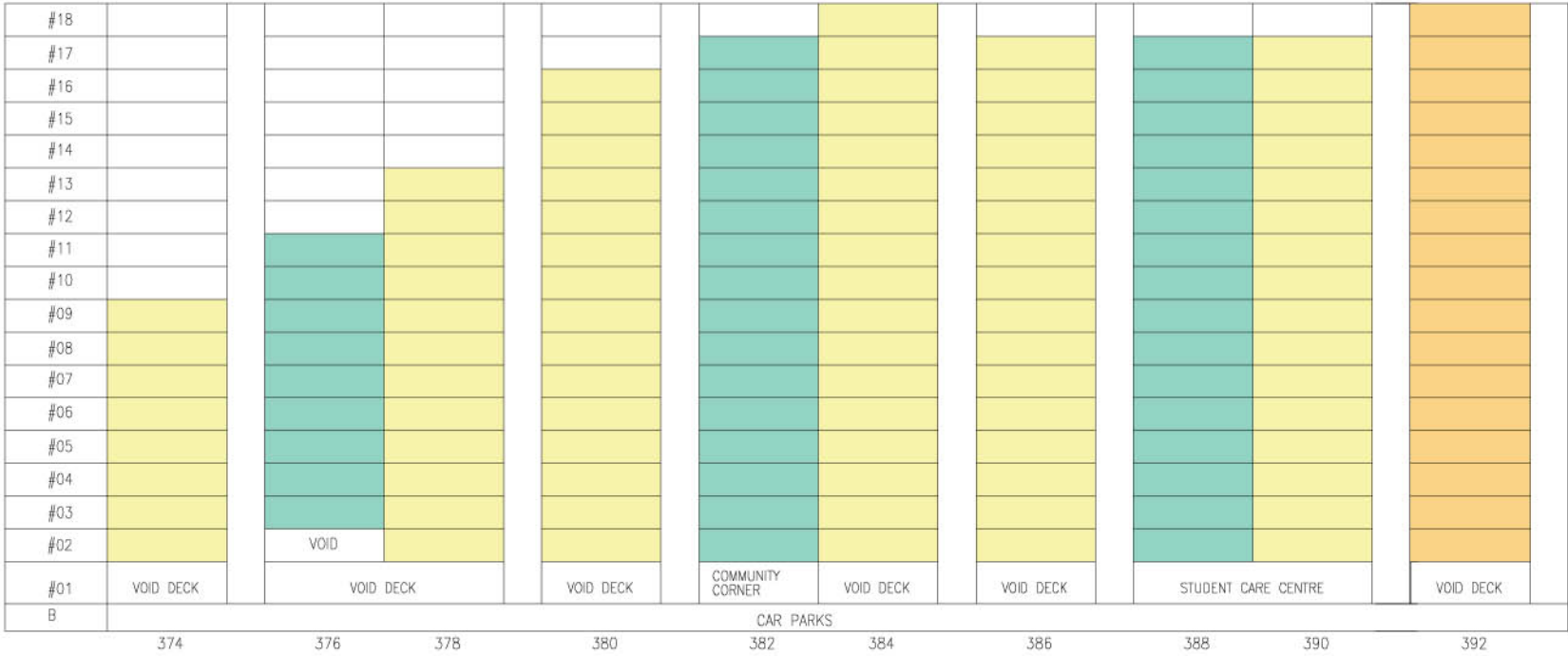
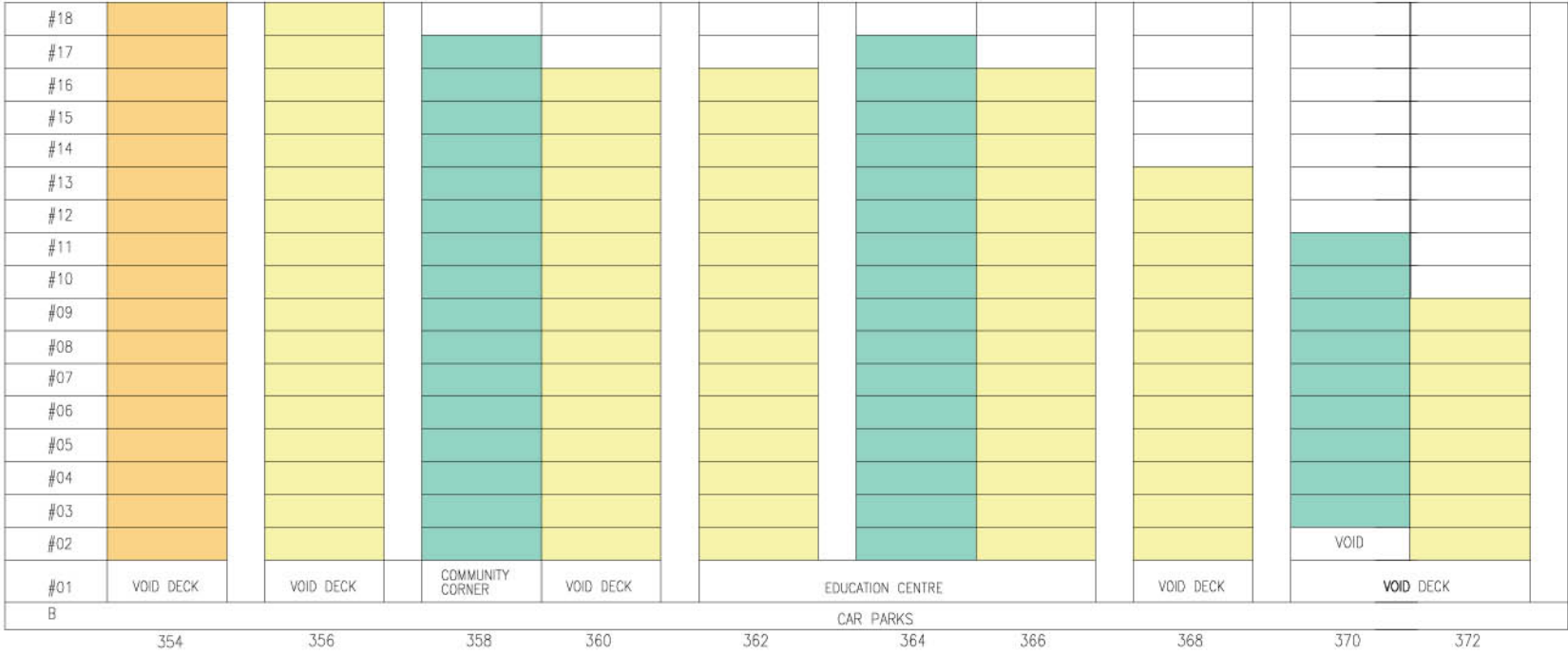

- BLOCK 308B
- 3 ROOM
 - 4 ROOM
 - 5 ROOM

Unit Distribution

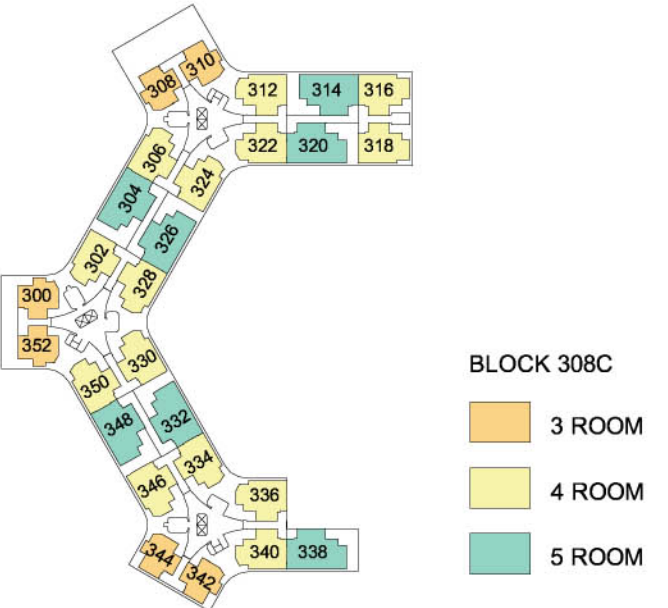
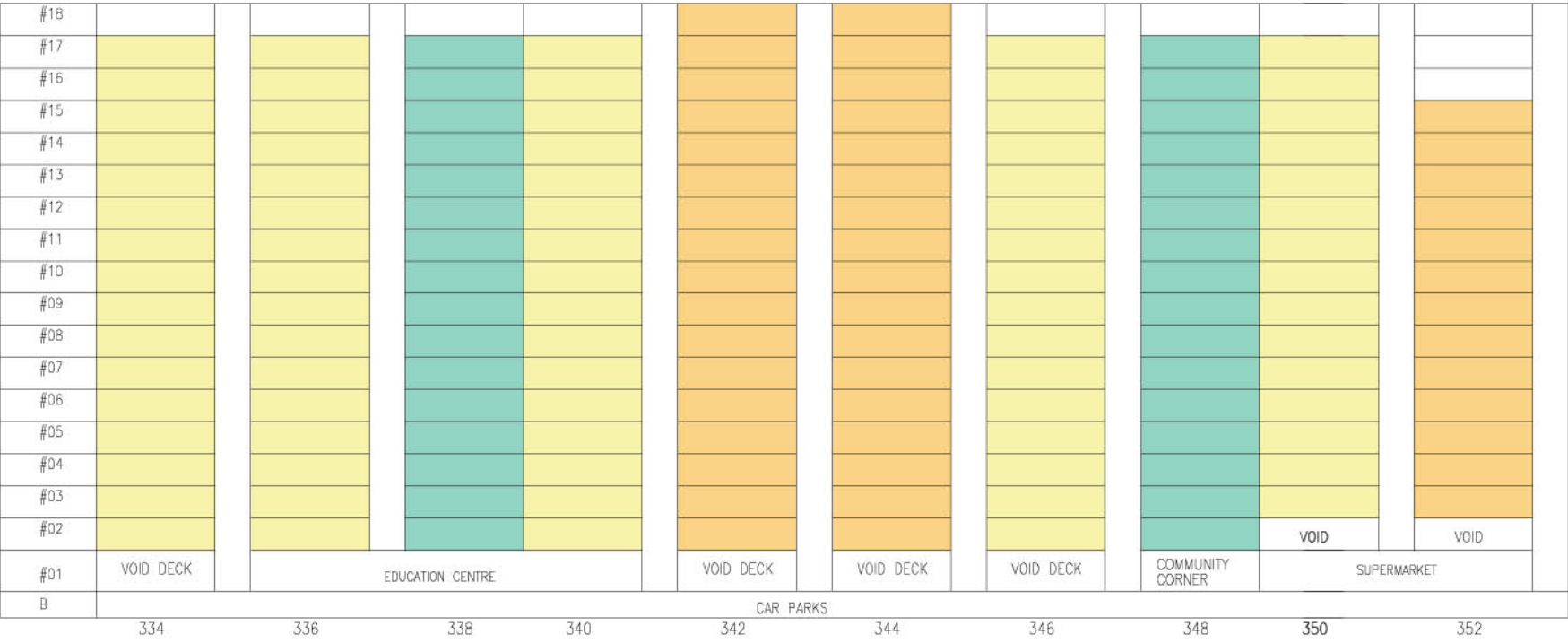
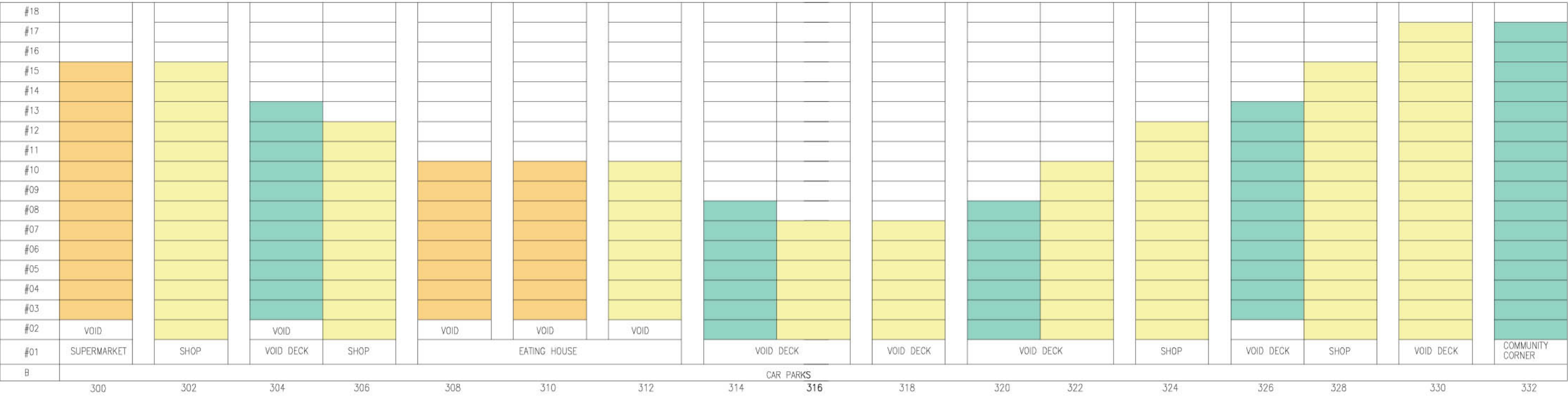

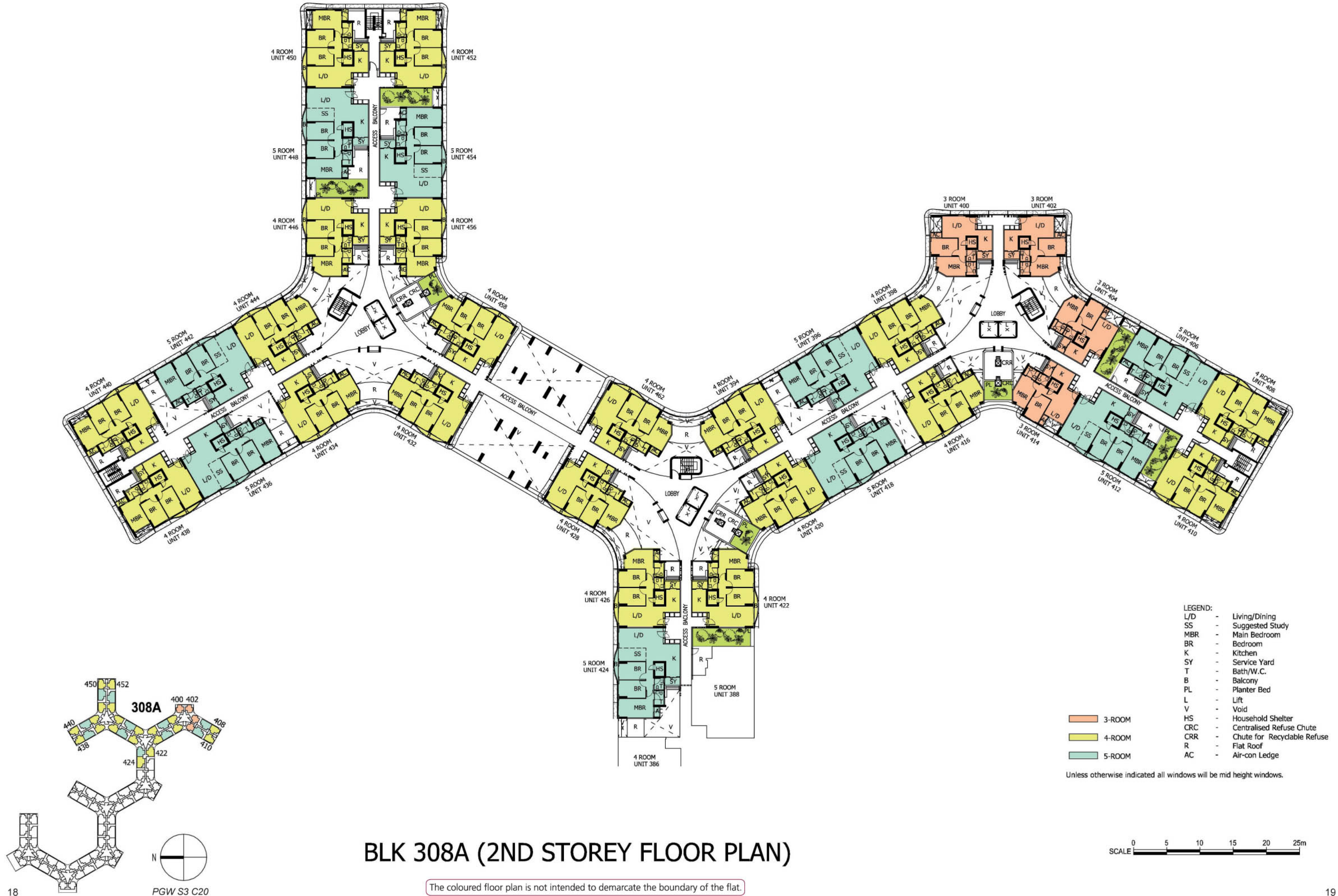

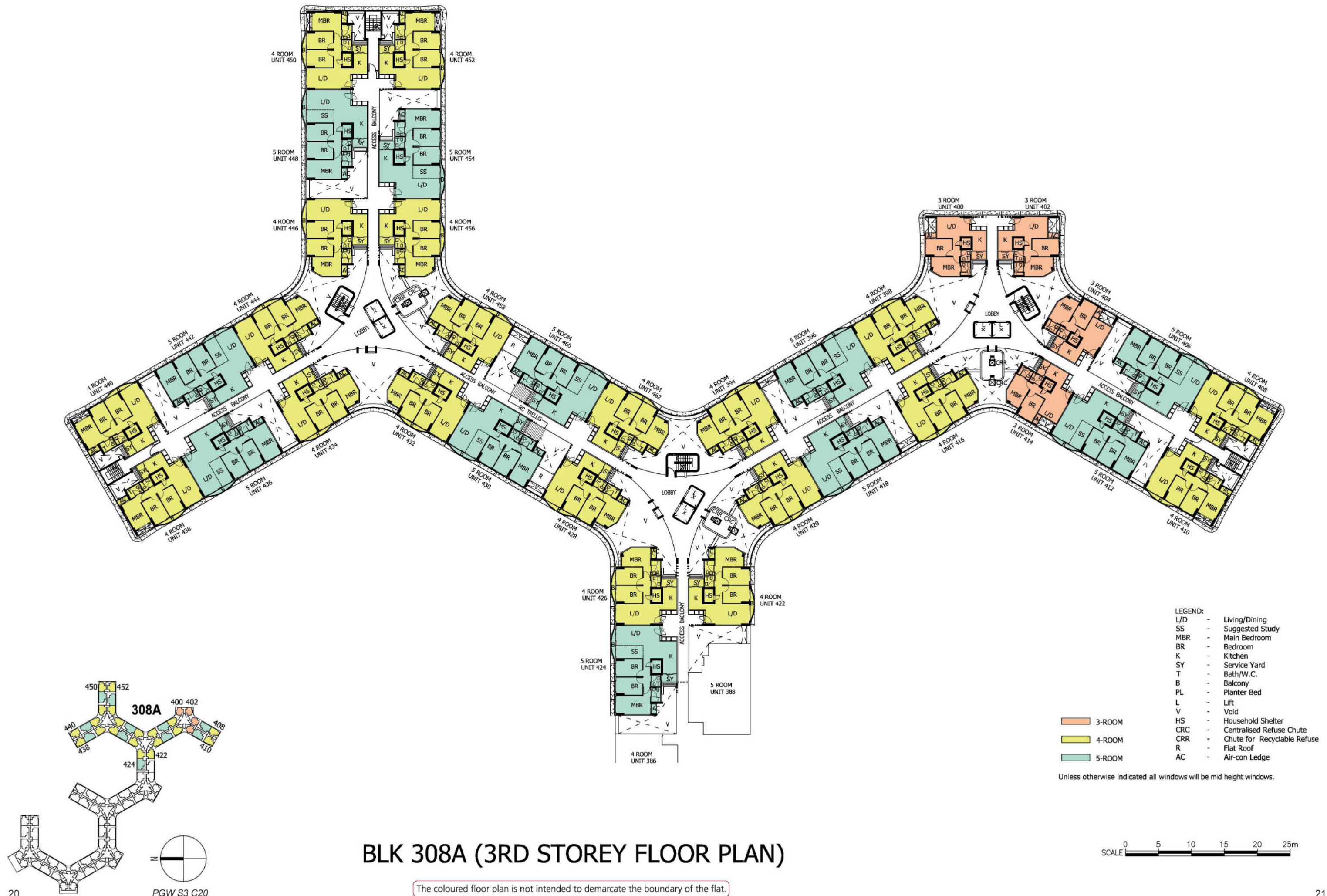

The coloured floor plan is not intended to demarcate the boundary of the flat.

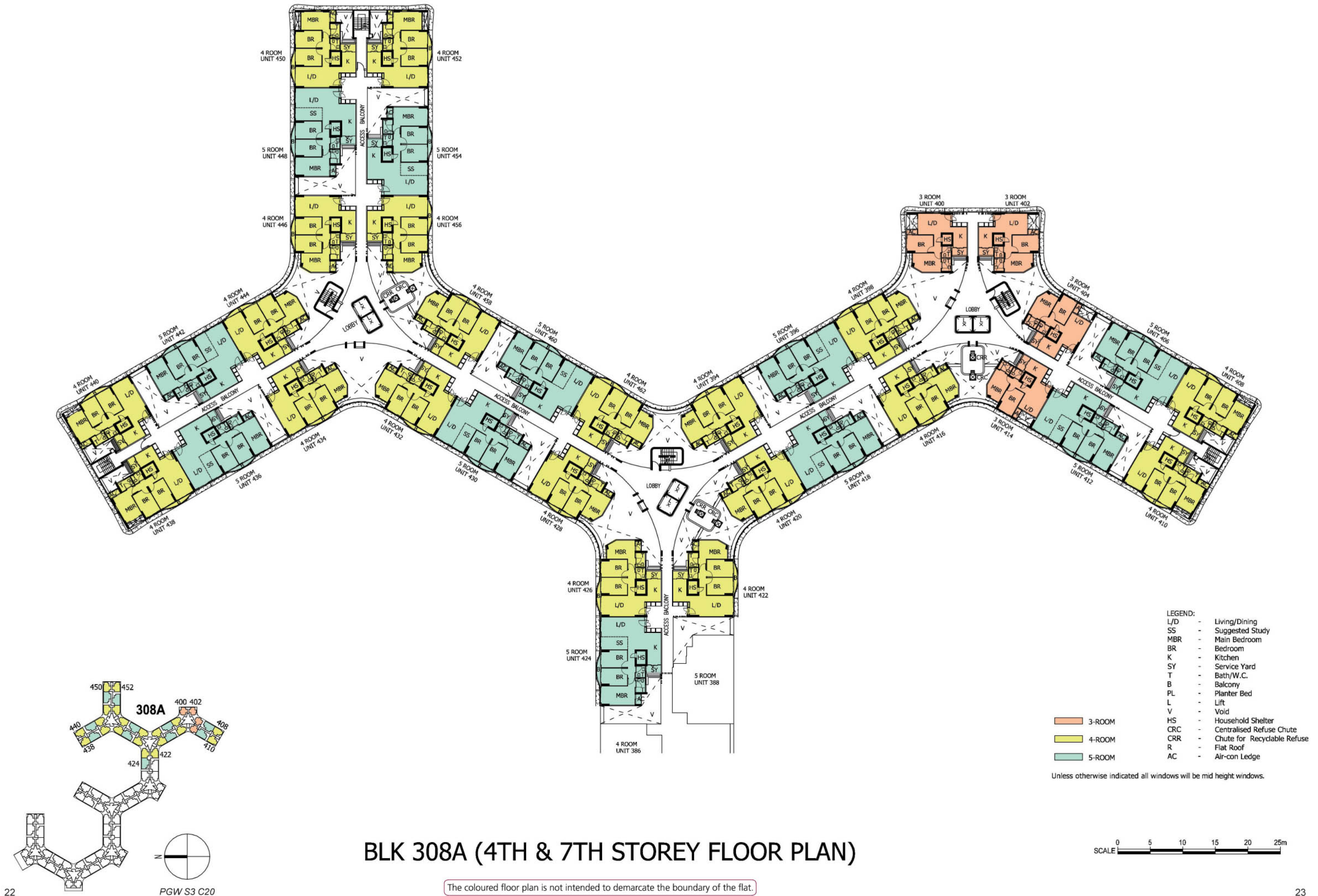

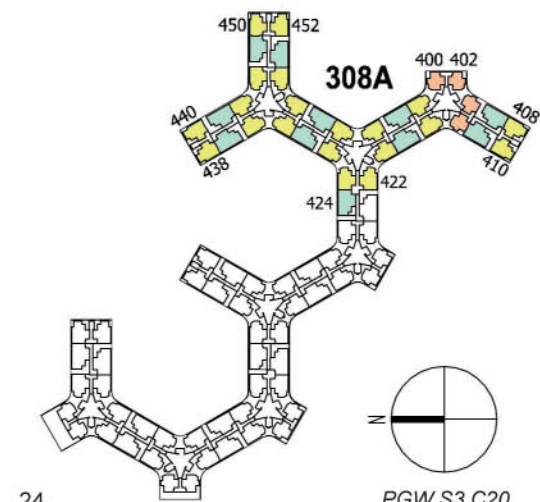

Unless otherwise indicated all windows will be mid height windows.

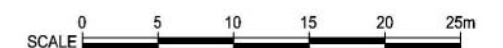

BLK 308A (5TH STOREY FLOOR PLAN)

The coloured floor plan is not intended to demarcate the boundary of the flat.



BLK 308A (8TH STOREY FLOOR PLAN)

The coloured floor plan is not intended to demarcate the boundary of the flat.



BLK 308A (9TH STOREY FLOOR PLAN)

The coloured floor plan is not intended to demarcate the boundary of the flat.



BLK 308A (10TH STOREY FLOOR PLAN)

The coloured floor plan is not intended to demarcate the boundary of the flat.



LEGEND:

L/D	- Living/Dining
SS	- Suggested Study
MBR	- Main Bedroom
BR	- Bedroom
K	- Kitchen
SY	- Service Yard
T	- Bath/W.C.
B	- Balcony
PL	- Planter Bed
L	- Lift
V	- Void
HS	- Household Shelter
CRC	- Centralised Refuse Chute
CRR	- Chute for Recyclable Refuse
R	- Flat Roof
AC	- Air-con Ledge

Unless otherwise indicated all windows will be mid height windows.

BLK 308A (12TH STOREY FLOOR PLAN)

The coloured floor plan is not intended to demarcate the boundary of the flat.

SCALE 0 5 10 15 20 25m

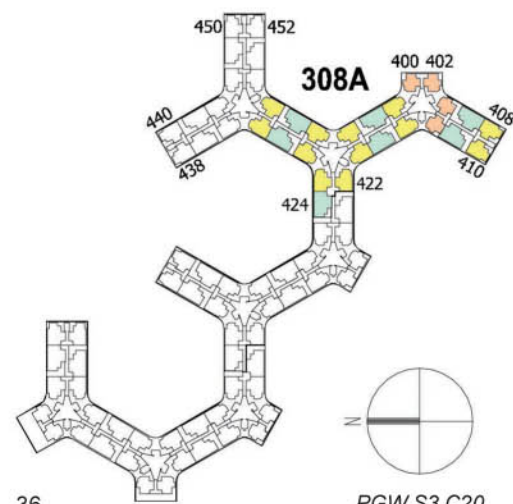



LEGEND:

L/D	- Living/Dining
SS	- Suggested Study
MBR	- Main Bedroom
BR	- Bedroom
K	- Kitchen
SY	- Service Yard
T	- Bath/W.C.
B	- Balcony
PL	- Planter Bed
L	- Lift
V	- Void
HS	- Household Shelter
CRC	- Centralised Refuse Chute
CRR	- Chute for Recyclable Refuse
R	- Flat Roof
AC	- Air-con Ledge

Unless otherwise indicated all windows will be mid height windows.

BLK 308A (13TH STOREY FLOOR PLAN)

The coloured floor plan is not intended to demarcate the boundary of the flat.

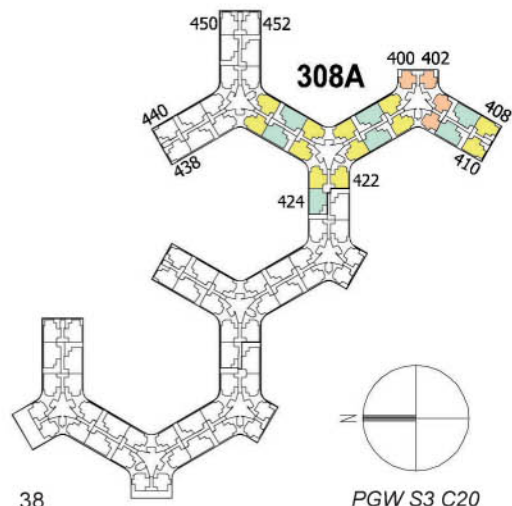



- LEGEND:
- L/D - Living/Dining
 - SS - Suggested Study
 - MBR - Main Bedroom
 - BR - Bedroom
 - K - Kitchen
 - SY - Service Yard
 - T - Bath/W.C.
 - B - Balcony
 - PL - Planter Bed
 - L - Lift
 - V - Void
 - HS - Household Shelter
 - CRC - Centralised Refuse Chute
 - CRR - Chute for Recyclable Refuse
 - R - Flat Roof
 - AC - Air-con Ledge

Unless otherwise indicated all windows will be mid height windows.

BLK 308A (14TH STOREY FLOOR PLAN)

The coloured floor plan is not intended to demarcate the boundary of the flat.

SCALE 0 5 10 15 20 25m

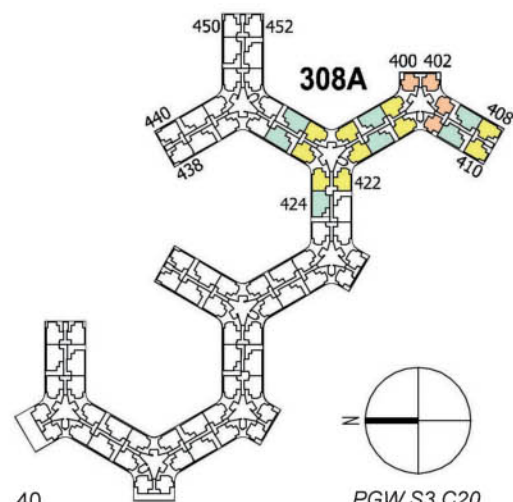



LEGEND:

L/D	-	Living/Dining
SS	-	Suggested Study
MBR	-	Main Bedroom
BR	-	Bedroom
K	-	Kitchen
SY	-	Service Yard
T	-	Bath/W.C.
B	-	Balcony
PL	-	Planter Bed
L	-	Lift
V	-	Void
HS	-	Household Shelter
CRC	-	Centralised Refuse Chute
CRR	-	Chute for Recyclable Refuse
R	-	Flat Roof
AC	-	Air-con Ledge

Unless otherwise indicated all windows will be mid height windows.

BLK 308A (15TH STOREY FLOOR PLAN)

The coloured floor plan is not intended to demarcate the boundary of the flat.

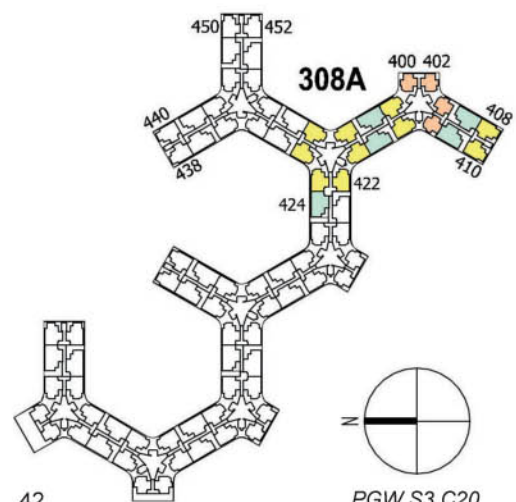

SCALE 0 5 10 15 20 25m



- LEGEND:
- L/D - Living/Dining
 - SS - Suggested Study
 - MBR - Main Bedroom
 - BR - Bedroom
 - K - Kitchen
 - SY - Service Yard
 - T - Bath/W.C.
 - B - Balcony
 - PL - Planter Bed
 - OT - Open Terrace
 - L - Lift
 - V - Void
 - HS - Household Shelter
 - CRC - Centralised Refuse Chute
 - CRR - Chute for Recyclable Refuse
 - R - Flat Roof
 - AC - Air-con Ledge

- 3-ROOM
- 4-ROOM
- 5-ROOM

Unless otherwise indicated all windows will be mid height windows.

BLK 308A (16TH STOREY FLOOR PLAN)

The coloured floor plan is not intended to demarcate the boundary of the flat.

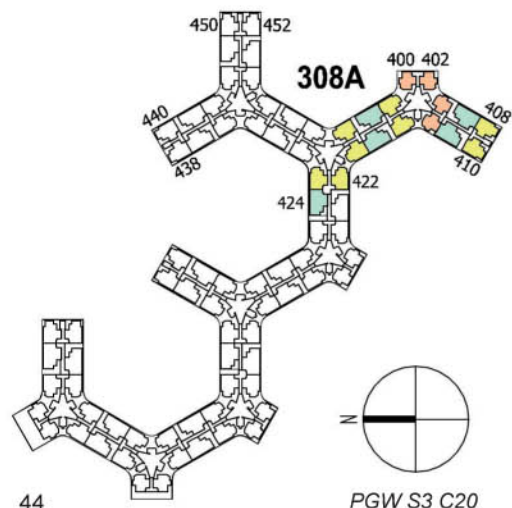
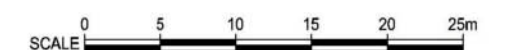



BLK 308A (17TH STOREY FLOOR PLAN)

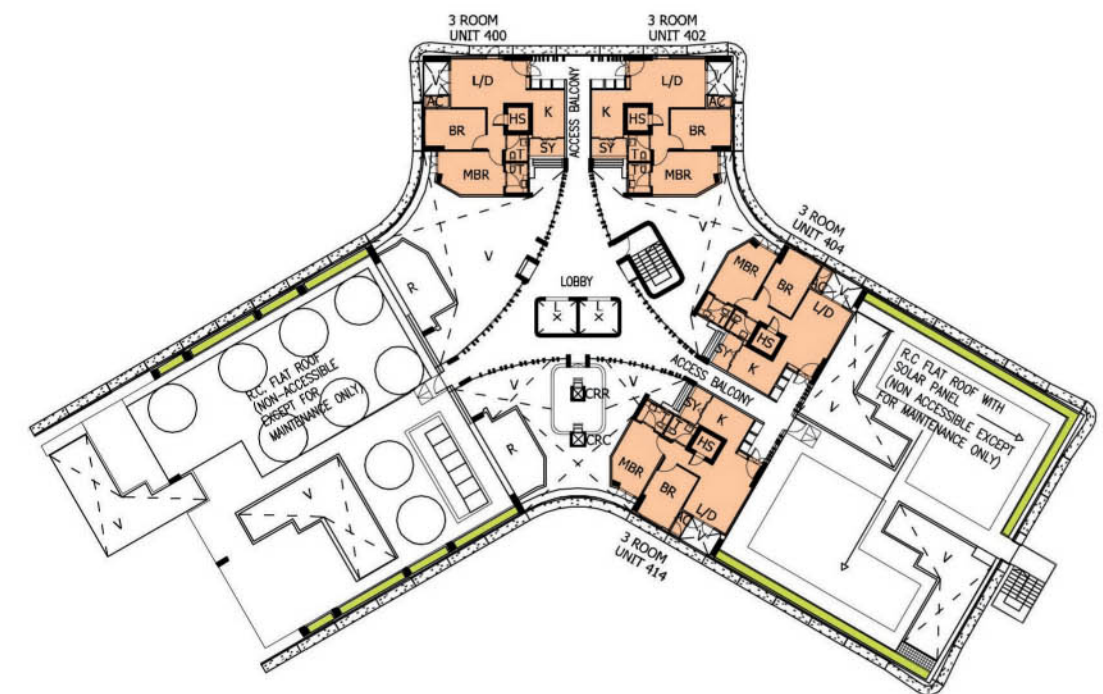

BLK 308A (18TH STOREY FLOOR PLAN)

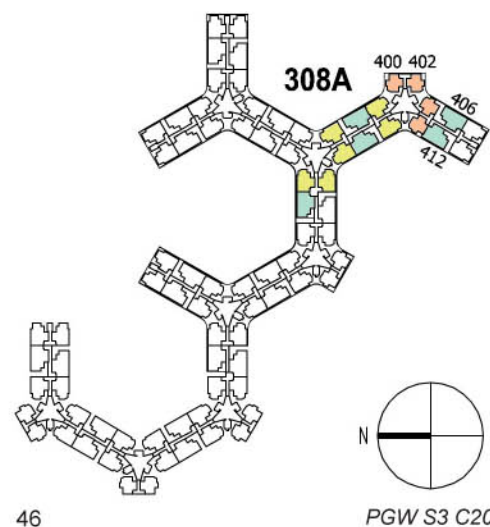

- LEGEND:
- L/D - Living/Dining
 - SS - Suggested Study
 - MBR - Main Bedroom
 - BR - Bedroom
 - K - Kitchen
 - SY - Service Yard
 - T - Bath/W.C.
 - B - Balcony
 - PL - Planter Bed
 - L - Lift
 - V - Void
 - HS - Household Shelter
 - CRC - Centralised Refuse Chute
 - R - Flat Roof
 - AC - Air-con Ledge

Unless otherwise indicated all windows will be mid height windows.

